

## DATASHEET

### XS4 Mini by SALTO

Stylish design is a SALTO trademark and with the XS4 Mini, we raise the bar on this already high standard thanks to its small, discreet size combined with a modern, clean LED aesthetic.

The Mini's smart compactness simplifies installation. Besides, it maintains the fire rating of the door as no additional drilling of the door is required.

[www.saltosystems.com](http://www.saltosystems.com)

### TECHNICAL SPECIFICATIONS: XS4 MINI Fx15x

**SALTO**  
inspired access



**TECHNICAL DATA:**

Reader dimensions (H x W x D):	127,0 x 58,5 x 22,5 mm
Weight	0,5 kg
Handle rotation:	Max. 45°
Door thicknesses:	35 mm - 100 mm
Square spindles:	8 mm
Power source:	3 AAA batteries (LR03 1,5V)
Number of openings:	40,000
Maximum events on lock audit	650 to 2.200 events
Environmental conditions (non-condensing):	+5 °C / +60 °C.
IP class:	Not suitable for outdoor use. Up to max. 80% humidity, non-condensing.
Certifications:	CE

**ID TECHNOLOGIES:**

MIFARE / DESFire:*	•
BLE Smart:	•
NFC:	•
Legic:**	—
HID iClass®:	•
Picopass:	—
i-Button:	—

\* MIFARE® (DESFire EV2, Plus, Ultralight C, Classic).

\*\* Legic Prime and Legic Advant

**TECHNOLOGY PLATFORMS:**

**SALTO SPACE:**

Smile - Selfprogrammable	—
ROM:	•
SVN data-on-card:	•
SALTO RFnet:	—
SALTO BLUEnet:	•
SALLIS:	—

**SALTO KS:**

SALTO KS:	•
-----------	---

**TECHNICAL DRAWING:**

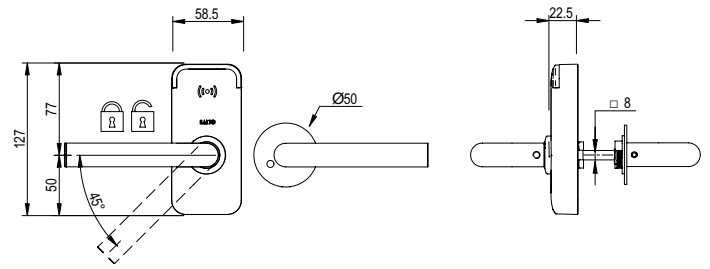

**HANDING REVERSIBLE**

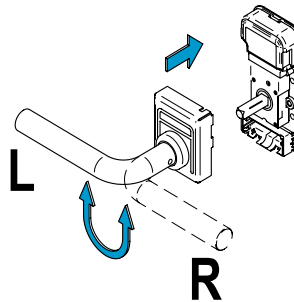

**OPENING MODES:**

Standard:	•
Office mode:	•
Timed office:	•
Automatic opening:	•
Automatic opening + office	•
Toggle:	•
Timed Toggle:	•
Amok mode:	—
Exit leaves open mode:	•
Pin code / Keypad:	—

**OPTIONS:**

**Reader colour:**

Black:	•
White:	•

**Handles finishes:**

IM Satin stainless steel:	•
IP Bright stainless steel:	—
IA Antique brass:	—
PP PVD bright brass type:	—
PM PVD satin brass type:	•
NE Black chromium:	—
BC BioCote anti-microbial:	•

**Handles**

Compatible handles	U, L, W, T, S
--------------------	---------------

**MODELS:**

**Fx150:**

2 handles any type.

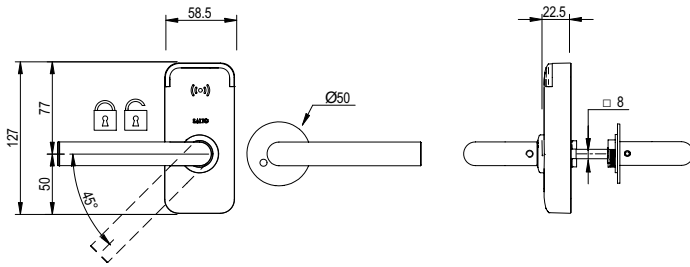

**Fx151:**

2 handles any type.  
Inside thumbturn.

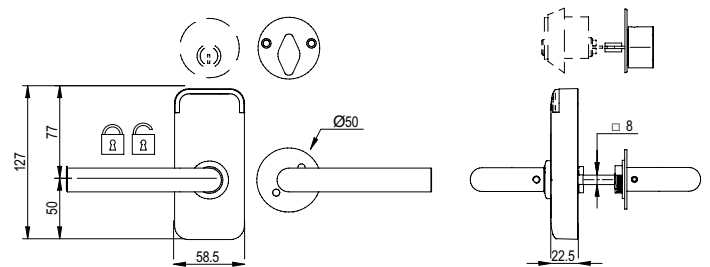

**Fx154:**

2 handles any type.  
Inside plate.  
• For mechanical emergency override.

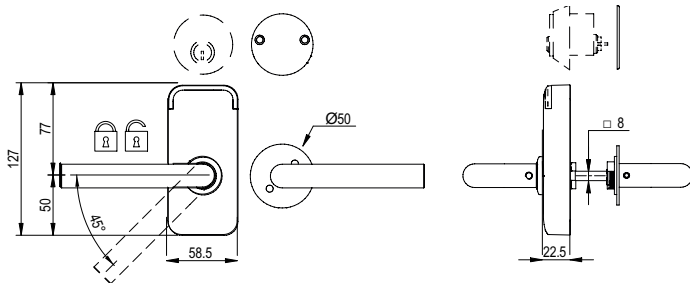

**Fx160:**

2 handles any type.  
Outside built in cover plate and inside plate.

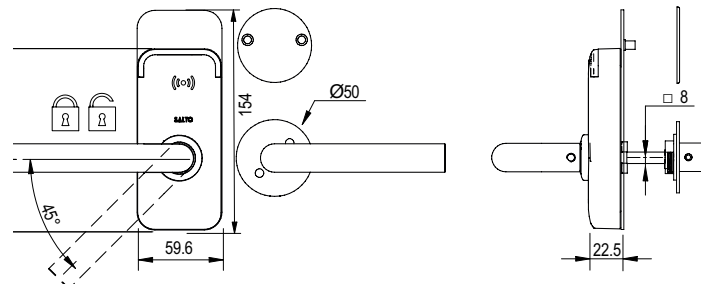

**Fx161:**

2 handles any type.  
Outside built in cover plate and inside thumbturn.

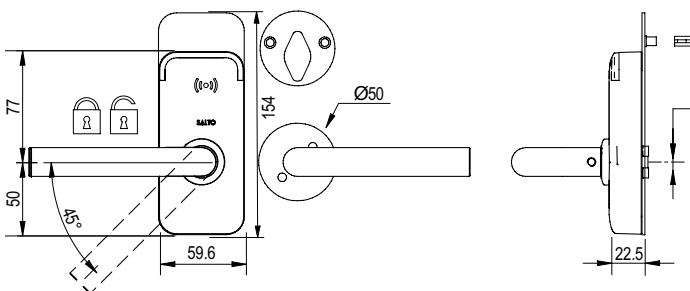

**Fx170:**

2 handles any type.  
Outside and inside built in cover plate.

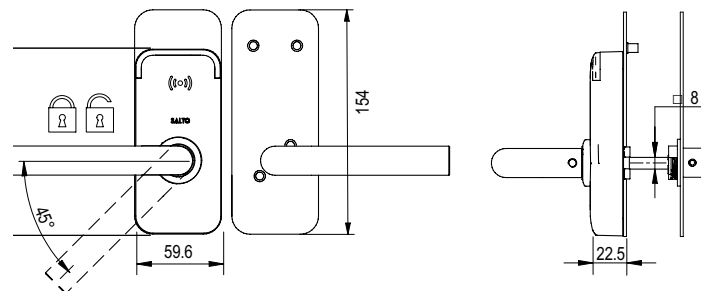

**Fx171:**

2 handles any type.  
Outside and inside built in cover plate and inside thumbturn.

